

Hearth Cabinet™

VENTLESS FIREPLACES



EXTERIOR FINISHES:

- BLACK POWDER COAT (*standard*)
- CUSTOM COLOR POWDER COAT
- BRUSHED STAINLESS STEEL
- SATIN BRASS

INTERIOR FINISHES:

- PORCELAIN PANELS
- HERRINGBONE TILE PATTERN
- RUNNING BRICK TILE PATTERN
- STAINLESS STEEL PANELS
- BRASS PANELS
- STAINLESS STEEL CURVED BACK
- CURVED BRASS BACK

DECORATIVE MEDIA:

- RIVER STONES (*standard*)
- CERAMIC LOGS
- GLASS CHIPS

SQUARE FIREBOX FAMILY
MODELS INCLUDED: #401, #402, #403

SPECIFICATIONS & DIMENSIONS:

- FIREBOX TO BE SECURED TO BASE (PROVIDED BY OTHERS) BY CONTRACTOR WITH FOUR SCREWS IN HOLES PROVIDED. NO OTHER ATTACHMENTS TO THE FIREBOX ARE PERMITTED.
 - DO NOT PUNCTURE BACK, TOP, FRONT OR SIDE WALLS OF FIREBOX IN ANY FASHION.
 - NO WEIGHT TO BE PUT ON FIREBOX.
 - MILLWORK OR WALL ABOVE MUST BE SELF SUPPORTED AND MAY NOT REST ON FIREBOX.
 - ALL WALL TREATMENTS BY OTHERS. FIRE RATED ASSEMBLIES OF PARTITIONS AND ANY OPENINGS ON PARTITIONS ARE THE RESPONSIBILITY OF OTHERS.
 - BASE PROVIDED BY OTHERS MUST BE ABLE TO SUPPORT 40 LBS PER SQUARE FOOT.
 - ALLOW 1/8" CLEARANCE ON TOP AND SIDES OF FIREBOX FRAME.
- 1 NO WOOD, LAMINATES, OR HEAT SENSITIVE MATERIALS MAY OCCUR ABOVE THE FACE OF THE FIREBOX FOR THE FIRST 12" ABOVE THE FIREBOX
 - 2 MILLWORK COMMENCING 12" ABOVE THE FIREBOX MAY PROTRUDE PAST THE FACE OF THE FIREBOX AT A 45 DEGREE ANGLE
 - 3 12" MINIMUM CLEARANCE TO NEAREST ELECTRONIC DEVICE OR AS SPECIFIED BY PRODUCT MANUFACTURER
 - 4 A NON-HEAT SENSITIVE LEDGE (BY OTHERS) MUST PROTRUDE A MIN. OF 3" PAST THE FACE OF ELECTRONIC DEVICE FOR HEAT DEFLECTION ABOVE FIREBOX AND BELOW ELECTRONIC DEVICE

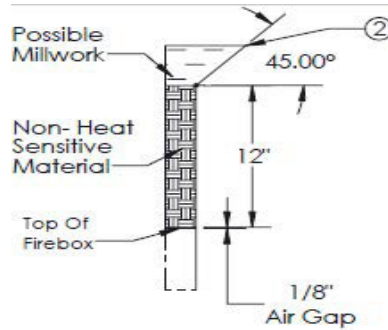

(A) SECTION DETAIL @ MILLWORK

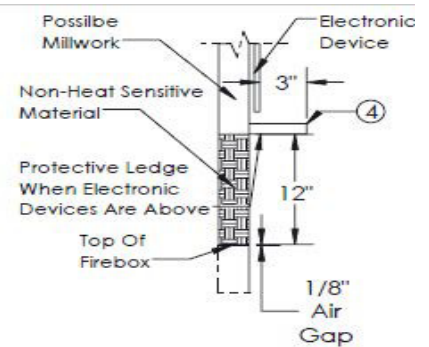

(B) SECTION DETAIL @ ELECTRONIC DEVICE

